

# Stratus OCT™

■ USB Hub & Key Instructions

---



---

### **Copyright**

© Carl Zeiss Meditec, Inc. All rights reserved.

### **Trademarks**

Stratus OCT™ is a trademark of Carl Zeiss Meditec, Inc. All other trademarks used in this document are the property of their respective owners.

## Stratus OCT — USB Hub & Key Instructions

This document provides instructions for connecting the peripherals approved for use with the Stratus OCT, which are: a USB hub and a USB (key type) storage device, with restrictions noted herein.

### USB Hub



**WARNING:** The device must have CE and FCC approvals. You must connect the hub as illustrated below. Do not use an external power supply to power the hub. Failure to observe these warnings could result in electrical shock to the patient and/or examiner. The only devices you may connect to the USB hub are the printer (installed on its shelf, as shown) and USB key storage devices. Use of non-approved USB devices may compromise the performance of other USB devices and may affect instrument safety

To install this device, we recommend you attach it to the lower shelf of the printer module using double-sided sticky tape, as shown in the diagram below.

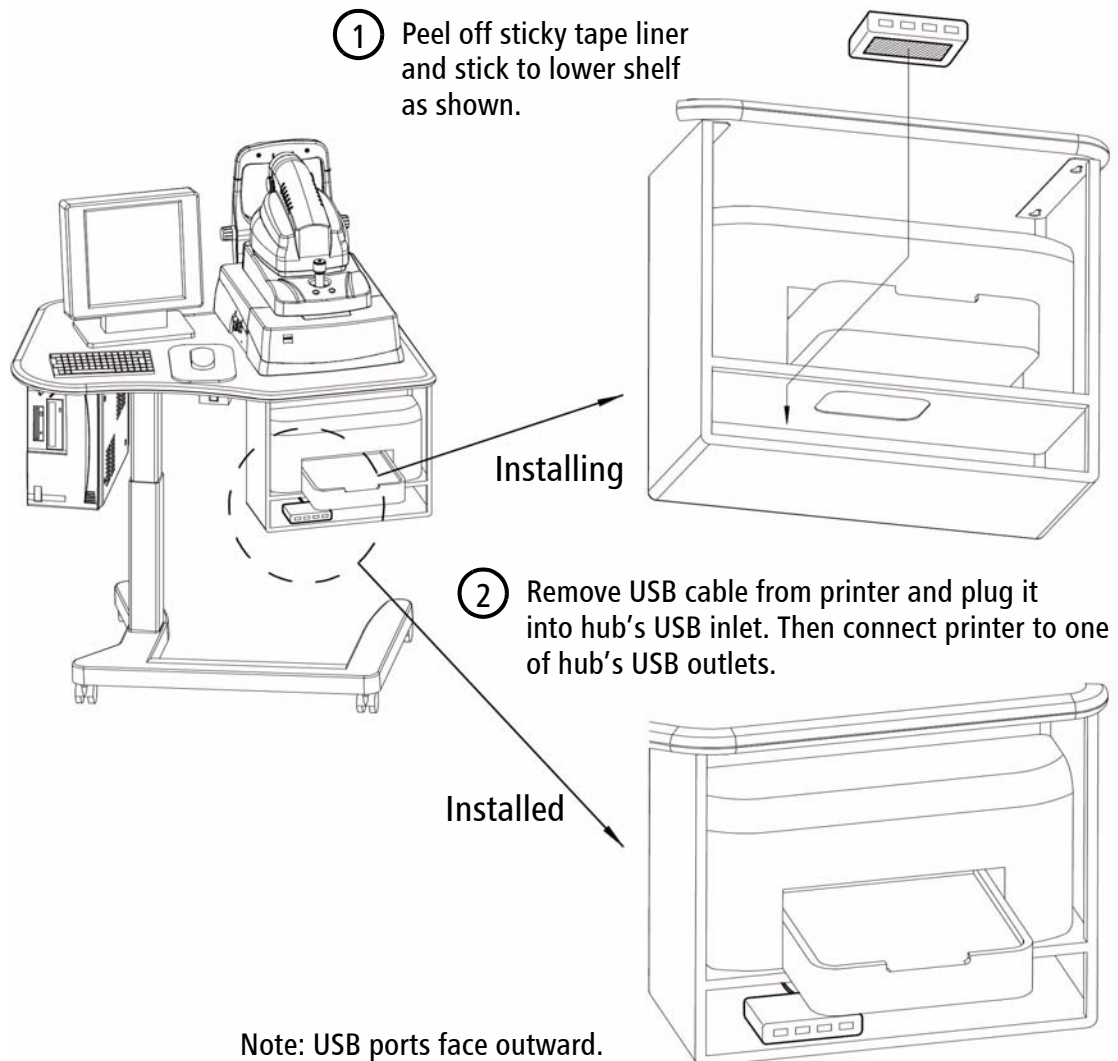

### USB (Key Type) Storage Device

This device is also known as a: USB thumb drive, USB pen drive, USB flash drive, USB jump drive, USB key drive, USB storage key, USB memory key and a USB key. It simply plugs into the USB port. To use this device, plug it into an available USB port on the properly installed USB hub.



**WARNING:** The device must have CE and FCC approvals. The storage device must be powered from a USB port on the properly installed USB hub only.

### Using the USB Key for Data Transfer

Once you install the USB key on the USB hub, the Stratus OCT computer automatically assigns a drive letter to it. To transfer data to the USB key, simply select its drive letter when exporting data from the Stratus OCT.



### WARNING: User Changes to Software or Hardware

The Stratus OCT is a medical device. The software and hardware have been designed in accordance with U.S., European and other international medical device standards designed to protect clinicians, users and patients from potential harm caused by mechanical, diagnostic or therapeutic failures. **Unauthorized modification of Stratus OCT software or hardware (including peripherals) can jeopardize the safety of operators and patients, the performance of the instrument, and the integrity of patient data; it also voids the instrument warranty.**



**Note:** Carl Zeiss Meditec does not provide technical support for the use of approved third party hardware or software. Please refer to the Stratus OCT Technical Support section of our website ([www.meditec.zeiss.com](http://www.meditec.zeiss.com)) for the current list of approved hardware and software.





Goeschwitzer Strasse 51–52  
07745 Jena  
Germany  
Telefon: +49 (0) 36 41 2 20-3 33  
Telefax: +49 (0) 36 41 2 20-2 82  
info@meditec.zeiss.com  
www.meditec.zeiss.com

**Carl Zeiss Meditec, Inc.**

5160 Hacienda Drive  
Dublin, CA 94568  
USA  
Toll Free: 1-800-341-6968  
Phone: 1-925-557-4100  
Fax: 1-925-557-4101  
info@meditec.zeiss.com  
www.meditec.zeiss.com



PN 62355 Rev. A 2006.07  
Stratus OCT™ — USB Hub & KeyInstructions  
Specifications subject to change